

NOTE: BREAK ALL CORNERS WITH 0.015" (.38 MM) RADIUS UNLESS OTHERWISE NOTED. STANDARD TOLERANCES TO APPLY UNLESS OTHERWISE SPECIFIED.

CUSTOMER PART No.	CUSTOMER CAN ART STD.	DIE No. EH05606
DESCRIPTION	1.25" x 3.00" x 0.120" RECT. TUBE	PROPOSAL No. H-7758

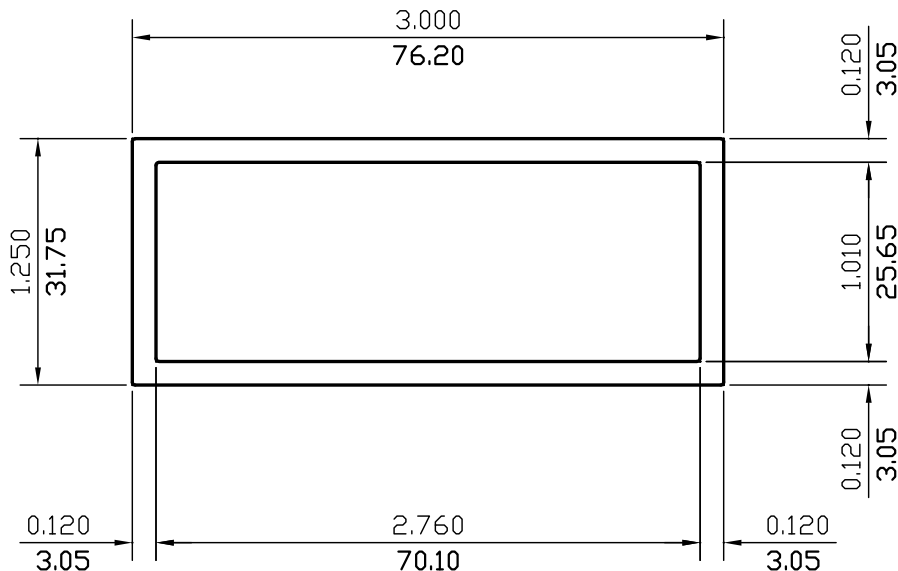

WALL THICKNESS 0.120 (3.05) EXCEPT AS SHOWN

DATE	REV	DESCRIPTION	BY
03/14/23	2	REMOVED ALLOY	JASON
09/26/00	1	UPDATED DRAWING	P.M.
EST.AREA	0.962	IN. ²	EST.AREA 620.907
			MM. ²
EST.WT.	1.136	LBS/FT.	EST.WT. 1.690
			KG/M.
EST.PER.	16.040	IN.	EST.PER. 407.416
			MM.
OUT PER.	8.500	IN.	OUT PER. 215.9
			MM.
C.C.D.	3.250	IN.	C.C.D. 82.550
			MM.
FACTOR	14	FINISH	M/F
		ALLOY & TEMP.	
CKD BY	SCALE 1:1	DWN BY	C.P. DATE 06/05/98

CAN ART

85 PARKSHORE DRIVE
BRAMPTON, ONT L6T 5M1
TEL. NO. (905) 791-1464
FAX NO. (905) 791-9151
E-MAIL: canart@canart.com

ALUMINUM EXTRUSION INC.

THIS DRAWING IS NOT NECESSARILY A COPY OF YOUR ORIGINAL. PLEASE APPROVE DIMENSIONS AND TOLERANCES INDICATED. CAN ART ASSUMES NO RESPONSIBILITY EITHER TECHNICAL OR LEGAL FOR HAVING THIS SHAPE MADE. THE CUSTOMER AGREES TO FULLY PROTECT CAN ART ALUMINUM FROM CLAIMS OF OTHERS RESULTING FROM THIS SHAPE.

SIGNED: _____ DATE: _____